

# PLASMA CUTTING

The new Torch  
without High Frequency Start

RPT Torches for **HYPERTHERM**<sup>®</sup> Plasma Systems without HF

MAX 40CS<sup>®</sup>  
MAX 42<sup>®</sup>  
MAX 43<sup>®</sup>  
MAX 43CS<sup>®</sup>  
POWERMAX<sup>®</sup> 600  
POWERMAX<sup>®</sup> 800  
POWERMAX<sup>®</sup> 900



**ST-120HY**  
**STM-120HY**

POWERMAX<sup>®</sup> 1000  
POWERMAX<sup>®</sup> 1250  
POWERMAX<sup>®</sup> 1650



**NEW**  
**Coaxial Cable**

● Higher performances

● Cleaner cut

● Faster speed



**RPT Torches for HYPERTHERM® Plasma Systems without HF**

**Type A** MAX 40CS® / 42® / 43® / 43CS® - Powermax® 600/800/900

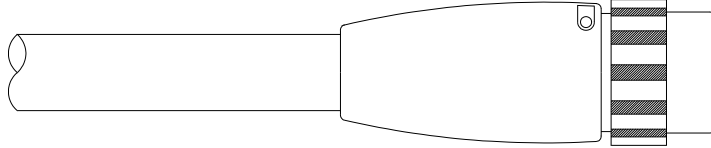

**Type B** Powermax® 600 Without Quick Disconnect

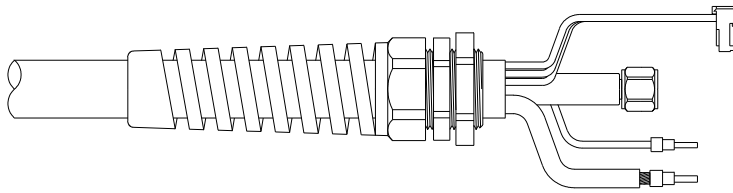

**Type C** Powermax® 1000 / 1250 / 1650

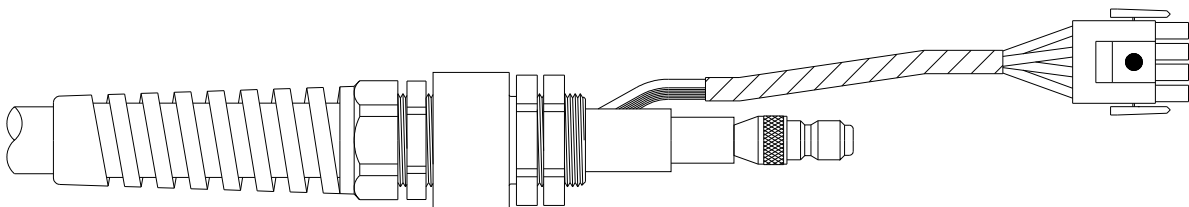

NOTE : HYPERTHERM, Max and powermax are registered trademarks of Hypertherm, Inc.



## RPT Torches for HYPERTHERM® Plasma Systems without HF

### Type A MAX 40CS® / 42® / 43® / 43CS® - Powermax® 600/800/900

Catalog #	Description
03818CX-HY	<b>ST-120</b> Hand Torch, 7.5m (25 ft) Leads,
03823CX-HY	<b>ST-120</b> Hand Torch, 15m (50 ft) Leads,
09880CX-HY	Lead Assembly, hand, 7.5m (25 ft) Length,
09885CX-HY	Lead Assembly, hand, 15m (50 ft) Length,
03828CX-HY	<b>STM-120</b> Machine Torch, 7.5m (25 ft) Leads,
03833CX-HY	<b>STM-120</b> Machine Torch, 15m (50 ft) Leads,
09890CX-HY	Lead Assembly, machine, 7.5m (25 ft) Length,
09895CX-HY	Lead Assembly, machine, 15m (50 ft) Length,

### Type B Powermax® 600 Without Quick Disconnect

Catalog #	Description
03819CX-HY	<b>ST-120</b> Hand Torch, 7.5m (25 ft) Leads,
03824CX-HY	<b>ST-120</b> Hand Torch, 15m (50 ft) Leads,
09881CX-HY	Lead Assembly, hand, 7.5m (25 ft) Length,
09886CX-HY	Lead Assembly, hand, 15m (50 ft) Length,
03829CX-HY	<b>STM-120</b> Machine Torch, 7.5m (25 ft) Leads,
03834CX-HY	<b>STM-120</b> Machine Torch, 15m (50 ft) Leads,
09891CX-HY	Lead Assembly, machine, 7.5m (25 ft) Length,
09896CX-HY	Lead Assembly, machine, 15m (50 ft) Length,

### Type C Powermax® 1000 / 1250 / 1650

	Catalog #	Description
<b>Powermax® 1000 - T60 1250 - T80</b>	03820CX-HY	<b>ST-120</b> Hand Torch, 7.5m (25 ft) Leads
	03825CX-HY	<b>ST-120</b> Hand Torch, 15m (50 ft) Leads
	09781CX-HY	Lead Assembly, hand, 7.5m (25 ft) Length
	09786CX-HY	Lead Assembly, hand, 15m (50 ft) Length
	03830CX-HY	<b>STM-120</b> Machine Torch, 7.5m (25 ft) Leads
	03835CX-HY	<b>STM-120</b> Machine Torch, 15m (50 ft) Leads
	09791CX-HY	Lead Assembly, machine, 7.5m (25 ft) Length
	09796CX-HY	Lead Assembly, machine, 15m (50 ft) Length
<b>Powermax® 1650 - T100</b>	03821CX-HY	<b>ST-120</b> Hand Torch, 7.5m (25 ft) Leads
	03826CX-HY	<b>ST-120</b> Hand Torch, 15m (50 ft) Leads
	09780CX-HY	Lead Assembly, hand, 7.5m (25 ft) Length
	09785CX-HY	Lead Assembly, hand, 15m (50 ft) Length
	03831CX-HY	<b>STM-120</b> Machine Torch, 7.5m (25 ft) Leads
	03836CX-HY	<b>STM-120</b> Machine Torch, 15m (50 ft) Leads
	09790CX-HY	Lead Assembly, machine, 7.5m (25 ft) Length
	09795CX-HY	Lead Assembly, machine, 15m (50 ft) Length

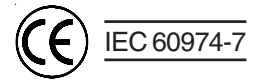

**RPT Torch for HYPER THERM®**  
**Plasma Systems without HF**

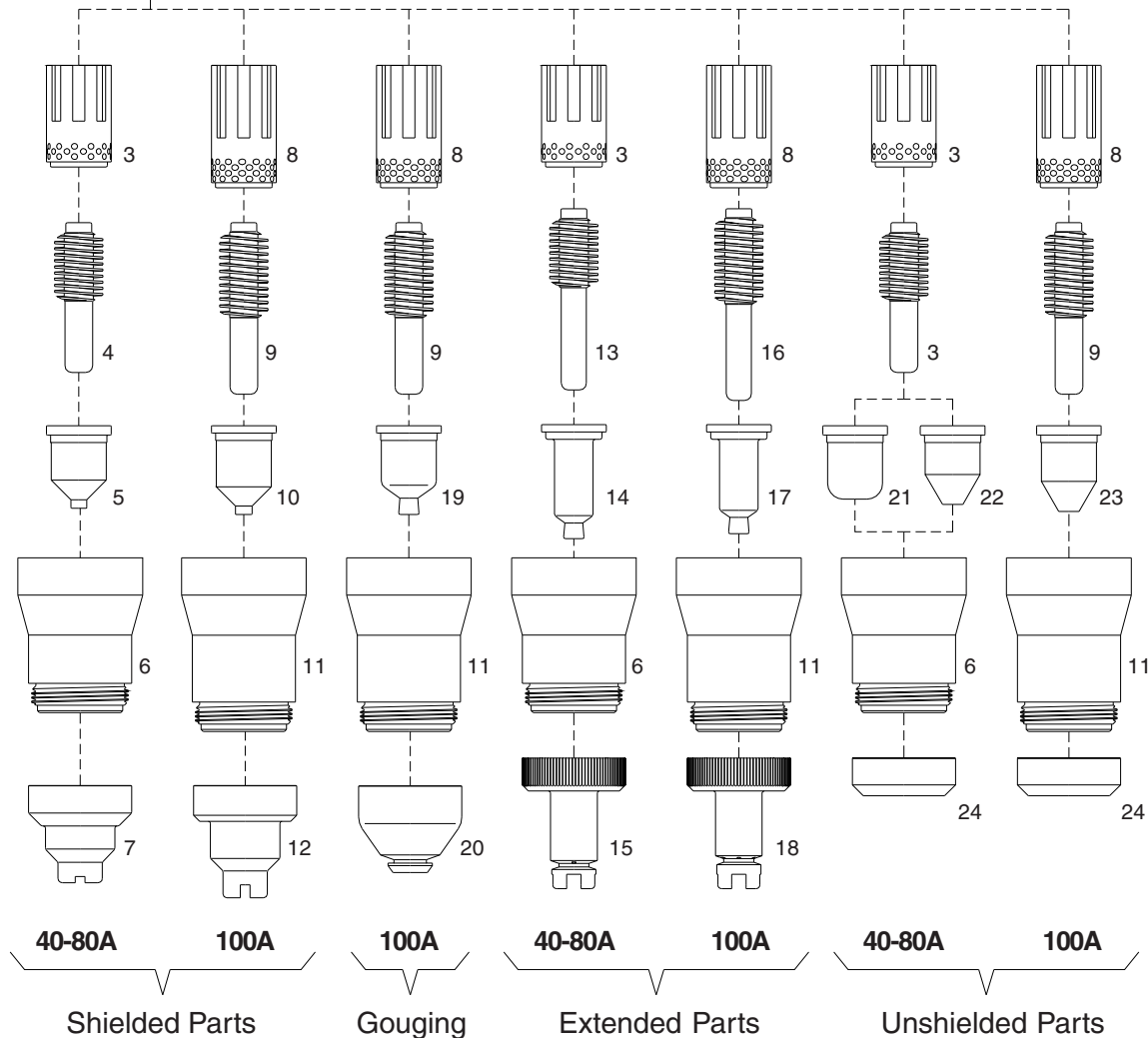
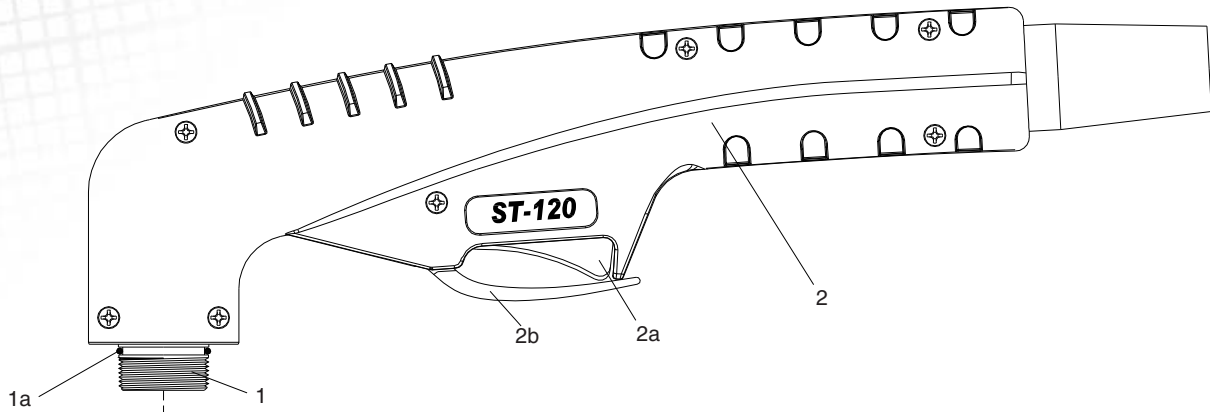

NOTE : HYPER THERM, Max and powermax are registered trademarks of Hypertherm, Inc.



# ST-120HY

## Replacement Parts **ST-120HY**

### Torch parts

Item #	Ref #	Catalog #	Description
1		03800	<b>ST-120</b> Hand Torch Head
1a		02800.60	O-Ring
2		09705	Handle with Switch
2a		07301.20	Switch
2b		09605.42	Safety Tab
<hr/>			
3	☆ ○ □ △	120925	60043 Swirl ring, 40-80A, <i>Maximum Life</i>
	☆ ○ □ △	120925	60043E Swirl ring, 40-80A
4	☆ ○ □ △	120926	52675 Electrode, 40-80A
5	☆ ○ □ △	120932	51405.10 Tip, 40A
	☆ ○ □ △	120931	51405.12 Tip, 60A
	□ △	120927	51405.14 Tip, 80A
6	☆ ○ □ △		60495 Retaining Cap, 40-80A
7	☆ ○ □ △	120929	51981/TD Shield Cap, Hand, 40-80A
<hr/>			
8	△	220051	60044 Swirl ring, 100A, <i>Maximum Life</i>
	△	220051	60044E Swirl ring, 100A
9	△	220037	52676 Electrode, 100A
10	△	220011	51406 Tip, 100A
11	△		60496 Retaining Cap, 100A
12	△	220065	51983/TD Shield Cap, Hand, 100A
<hr/>			
13	☆ ○ □ △		52675L Extended Electrode, 40-80A
14	☆ ○ □ △		51405L.10 Extended Tip, 40A
	☆ ○ □ △		51405L.12 Extended Tip, 60A
	□ △		51405L.14 Extended Tip, 80A
15	☆ ○ □ △		60505L Extended Shield Cap, Hand, 40-80A
16	△		52676L Extended Electrode, 100A
17	△		51406L.15 Extended Tip, 100A
18	△		51983L Extended Shield Cap, Hand, 100A
<hr/>			
19	○ □ △	51409.24	Tip, Gouging
20	○ □ △	51989G	Shield Cap, Gouging
<hr/>			
21	☆ ○ □ △	220006	51402 Tip, 40A, Unshielded
22	☆ ○ □ △	220007	51403 Tip, 60A, Unshielded
	□ △	120980	51404 Tip, 80A, Unshielded
23	△	220064	51408 Tip, 100A, Unshielded
24	☆ ○ □ △	120979	51939 Deflector

### Accessories

Item#	Ref #	Catalog #	Description
N/S	☆ ○ □	51865	Circle Cutting Attachment

- ☆ PowerMax® 600/800/900, MAX 40CS®, MAX 42®, MAX 43®, MAX 43CS®
- PowerMax® 1000
- PowerMax® 1250
- △ PowerMax® 1650



**TEC.MO.®**

**STM-120HY**

**RPT Torch for HYPER THERM®**  
**Plasma Systems without HF**

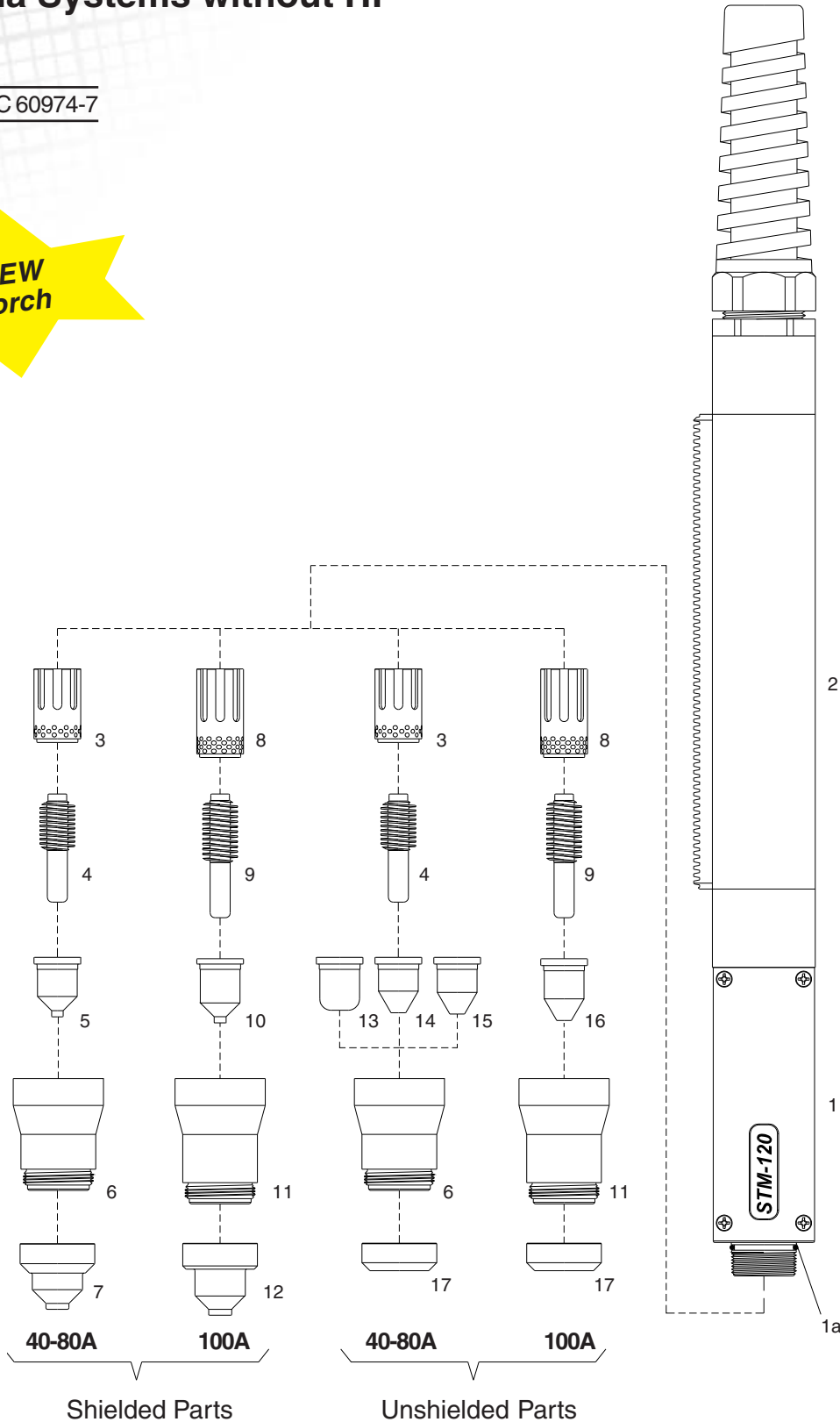

NOTE : HYPER THERM, Max and powermax are registered trademarks of Hypertherm, Inc.

TECMO®

STM-120HY

Replacement Parts **STM-120HY**

## Torch parts

Item #		Ref #	Catalog #	Description
1			03810	<b>STM-120</b> Machine Torch Head
1a			02800.60	O-Ring
2			07216	Fiberglass Positioning Tube with Rack
<hr/>				
3	☆ ○ □ △	120925	60043	Swirl ring, 40-80A, <i>Maximum Life</i>
	☆ ○ □ △	120925	60043E	Swirl ring, 40-80A
4	☆ ○ □ △	120926	52675	Electrode, 40-80A
5	☆ ○ □ △	120932	51405.10	Tip, 40A
	☆ ○ □ △	120931	51405.12	Tip, 60A
	□ △	120927	51405.14	Tip, 80A
6	☆ ○ □ △		60495	Retaining Cap, 40-80A
7	☆ ○ □ △	120930	51982/TD	Shield Cap, Machine, 40-80A
<hr/>				
8	△	220051	60044	Swirl ring, 100A, <i>Maximum Life</i>
	△	220051	60044E	Swirl ring, 100A
9	△	220037	52676	Electrode, 100A
10	△	220011	51406	Tip, 100A
11	△		60496	Retaining Cap, 100A
12	△	220047	51984/TD	Shield Cap, Machine, 100A
<hr/>				
13	☆ ○ □ △	220006	51402	Tip, 40A, Unshielded
14	☆ ○ □ △	220007	51403	Tip, 60A, Unshielded
15	□ △	120980	51404	Tip, 80A, Unshielded
16	△	220064	51408	Tip, 100A, Unshielded
17	☆ ○ □ △	120979	51939	Deflector

☆ PowerMax® 600/800/900, MAX 40CS®, MAX 42®, MAX 43®, MAX 43CS®

○ PowerMax® 1000

□ PowerMax® 1250

△ PowerMax® 1650

